

54

South Carolina  
Pursuant to a  
Warrant from Wm  
Davis Thomas Esq  
Locations for Green  
ville district, dated  
the 7<sup>th</sup> Decr 1807  
I have admeasured  
& laid out unto Danl  
Wilbanks a tract of  
Land Containing  
Fifty two acres.

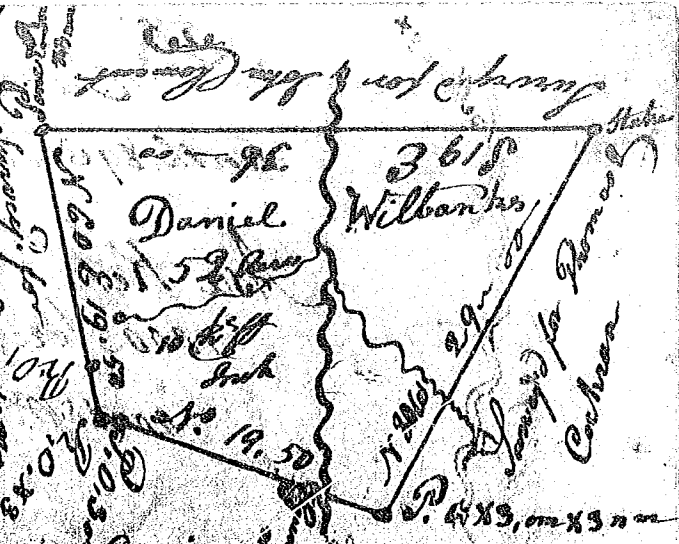

Situate in said District on a  
branch of Thompsons Beaverdam creek  
waters of Middle Tyeer river: Bounded by a line running  
N E by land Survey'd for Elisha Thompson N. by the  
ancient boundary line, N W by land Survey'd for Thomas  
& Cochean S E by land Survey'd for John Clement  
with such Farm and Marks as the above plat represents  
Survey'd the 28<sup>th</sup> Decr 1807 Danl Wilbanks D. S.  
Recorded 17<sup>th</sup> Augt 1809 Ch. Lawrence Esq. Thomas Esq. Elisha Thompson

*[Faint, mostly illegible handwritten text, likely bleed-through from the reverse side of the page.]*